

First three chapters (free download)



16-12-2017

VW BULLI CAMPER

Woodworking with machines and also hand tools can be dangerous. Don't start this project without an advanced knowledge about woodworking and (power) tools.

You can make this project with different woodworking machines, but in my opinion you need at least a saw (I prefer a band saw), a (small) jointer, sanding machine (one type of), a (small) router and a drill press.

All the parts in this pattern are drawn in a 1:1 scale. Sometimes a situation view has a 1:2 scale. There are 20 chapters. You don't necessarily need to start with chapter 1 if you feel like another chapter is more suitable to start with.

Besides the pattern itself there is also:

1. A 1:1 PDF (printable on Letter and A4 papersize) with templates.
2. A PDF (A2 paper size, with scaling printable as Letter and A4) from breakdown and build (made by Ducky).
3. A video of VW breakdown and build (made by Ducky).
4. A full 3D drawing in Sketchup (.skp) called "VW Bulli camper by Dutchy" (made by Ducky).
5. A PDF with 19 pictures of the already build prototyp. Be aware that for improvement of this pattern a few things are changed. The most important are the higher side doors and the pack rack support.

We recommend you to use Acrobat Reader for printing as we have experienced scaling issues with other PDF readers. Make sure to disable Scale to Fit and print at 100% scale for the prints to be exactly the right dimensions. Every template page includes a scale in both metric and imperial units for you to verify that the print has been printed correctly.

It isn't necessary to print all the pages, however It is recommended to print at least the templates.

You can download a Sketchup viewer (or SketchUp Make) for free at:

<https://www.sketchup.com/download/all>

Use PVAc wood glue and/or super glue (cyanoacrylate)

Small dowels of 2 mm are toothpicks. You can however also use smaller toothpicks, but be aware to make a corresponding hole. Further you need some dowels from 2.5-8 mm.

- 1*200 mm (8") 2.5 mm
- 2*500 mm (20") 3 mm
- 1*100 mm (4") 4 mm
- 1*200 mm (8") 5 mm
- 1*250 mm (10") 8 mm

All drawing sizes are in metric. This means that also the holes are in metric. You can however use imperial sized drill bits and dowels.

- Use a **3/32"** drill bit/dowel (2.38 mm) where a **2.5 mm** hole is drawn.
- Use a **1/8"** drill bit/dowel (3.17 mm) where a **3 mm** hole is drawn.
- Use a **5/32"** drill bit/dowel (3.96 mm) where a **4 mm** hole is drawn.
- Use a **3/16"** drill bit/dowel (4.76 mm) where a **5 mm** hole is drawn.
- Use a **1/4"** drill bit/dowel (6.35 mm) where a **6 mm** hole is drawn.
- Use a **5/16"** drill bit/dowel (7.94 mm) where a **8 mm** hole is drawn.
- Use a **1 1/4"** drill bit (31.75 mm) where a **30 mm** hole is drawn.
- Use a **1 1/2"** drill bit (38.1 mm) where a **40 mm** hole is drawn.

When you are using the templates and glue them (with spray glue or a glue stick) on the wood, almost no measuring is needed!

When you see shortcomings please send us an email so we may improve the pattern.

Enjoy building.

Dutchy

Without permission duplication and/or distribution of this pattern and/or the Sketchup file, in whole or in part, in any manner, is prohibited.

1 CABIN

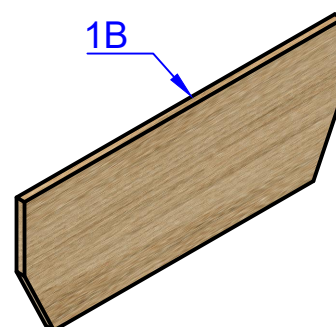
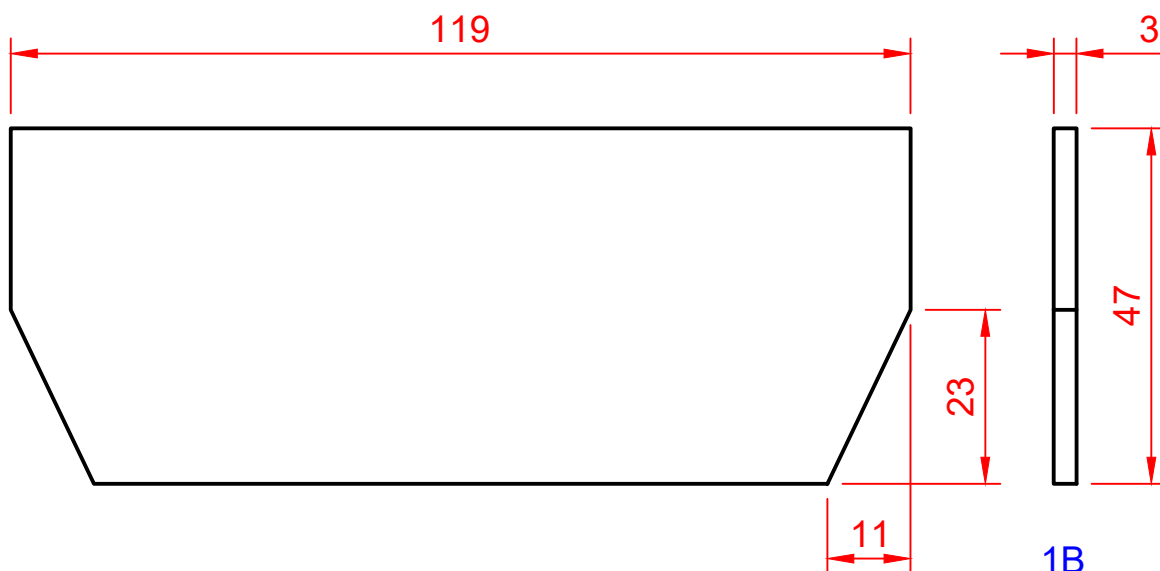
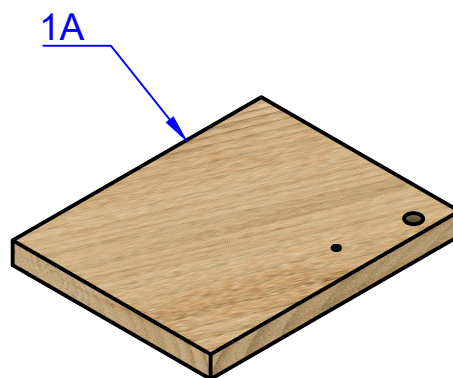
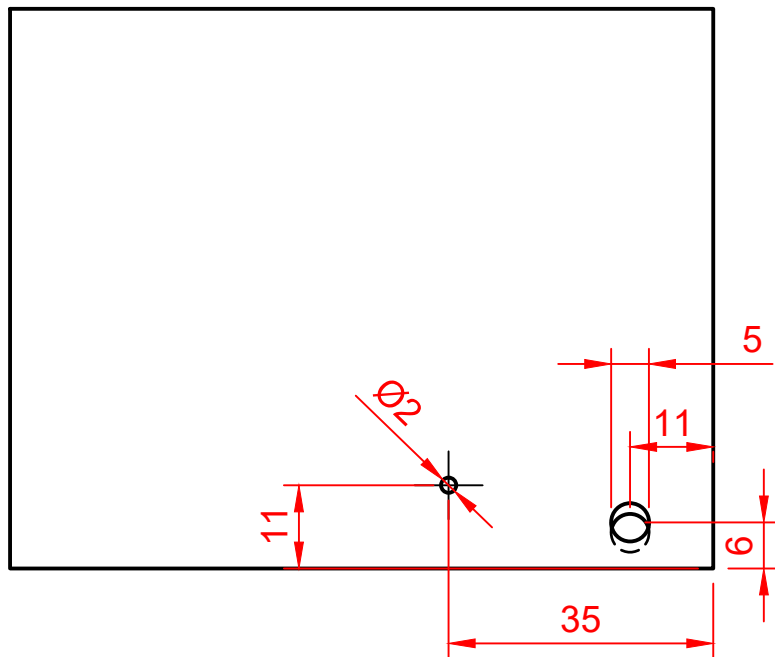
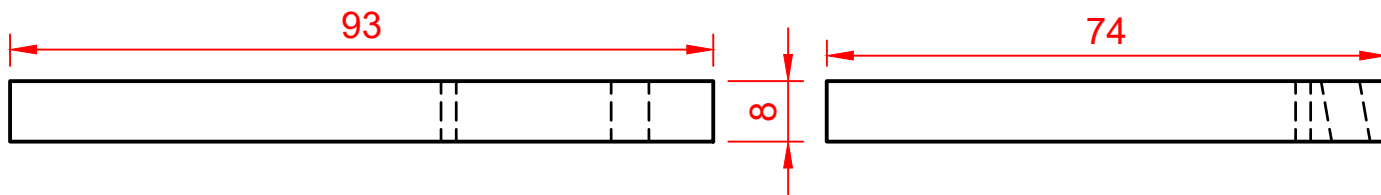

1 CABIN

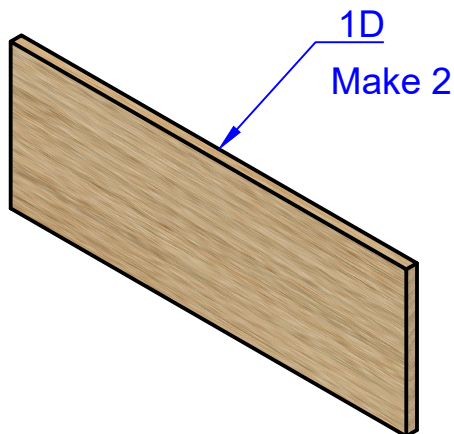
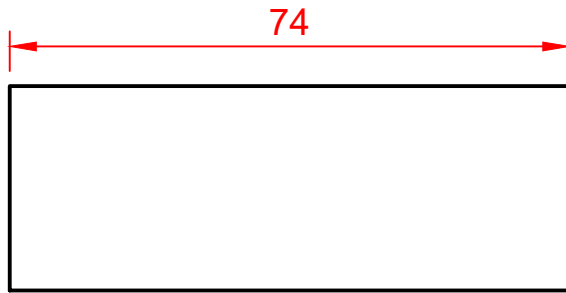
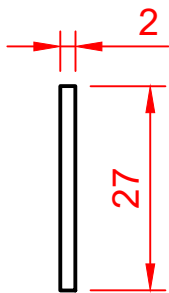
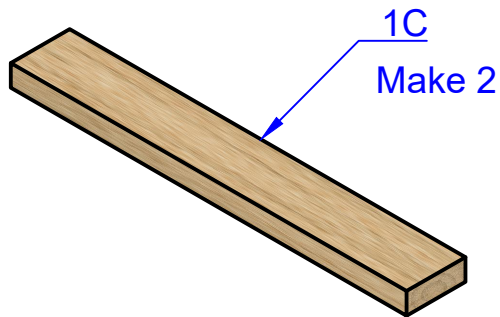
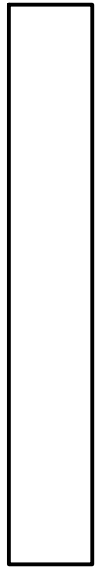
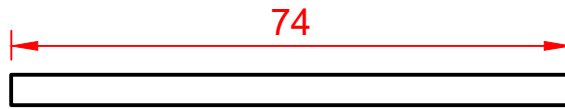
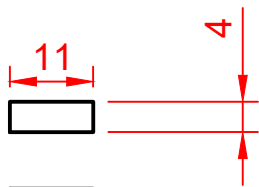

ASSEMBLE VIEW

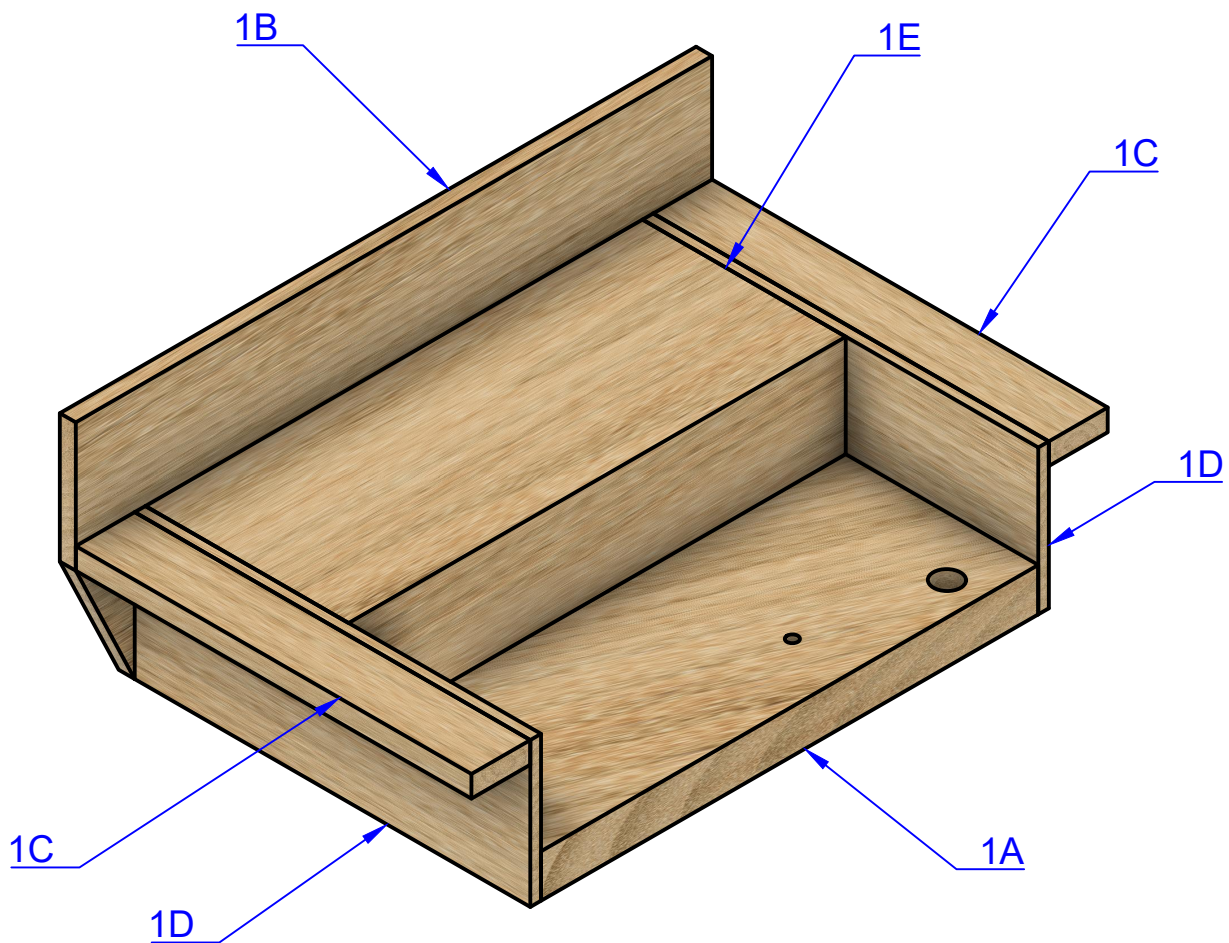
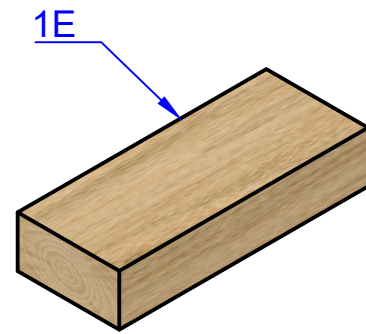
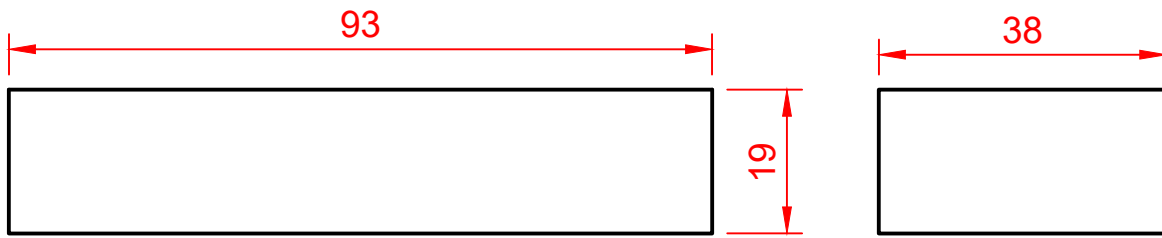

2 SEATS

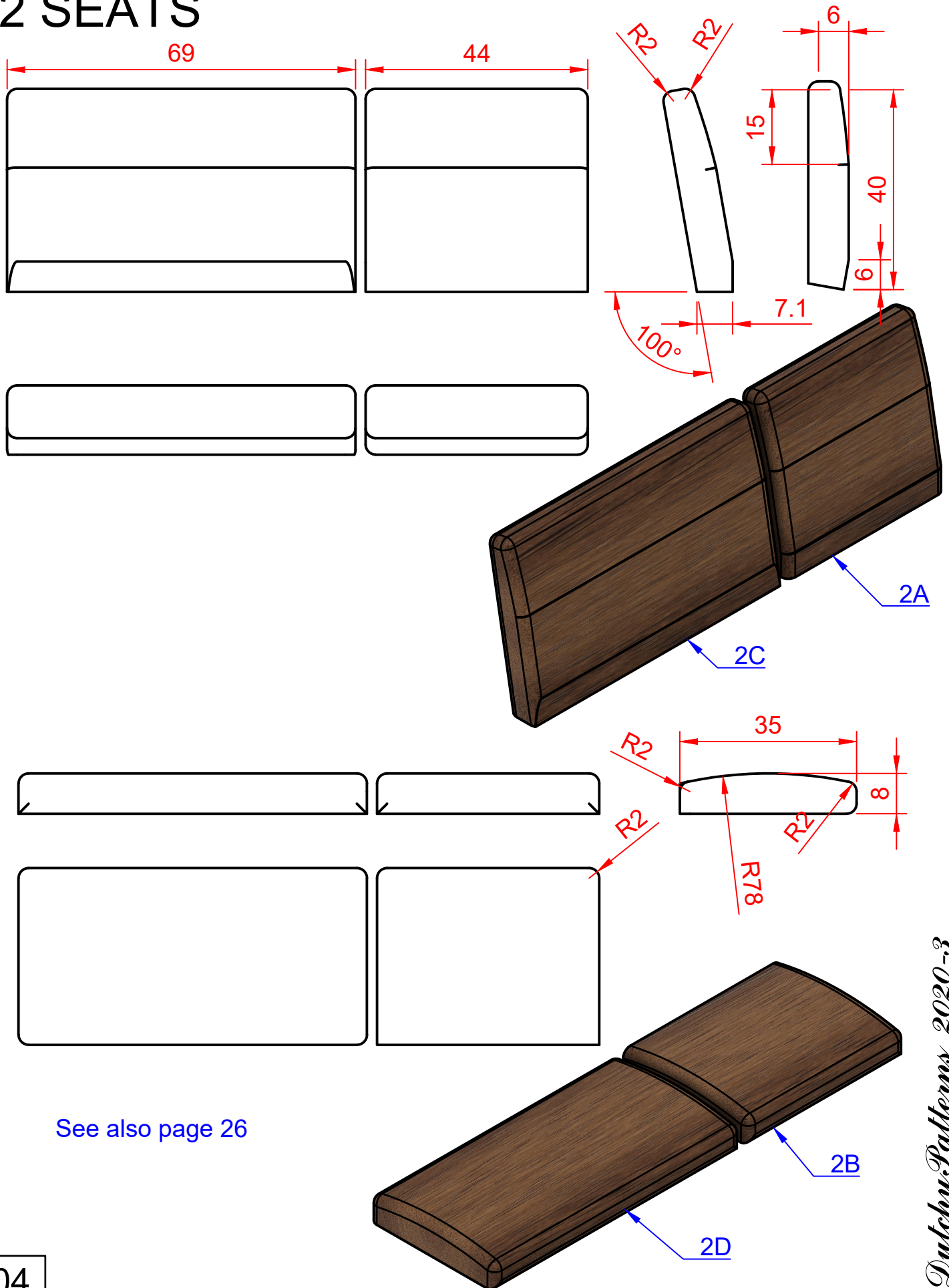

ASSEMBLE VIEW

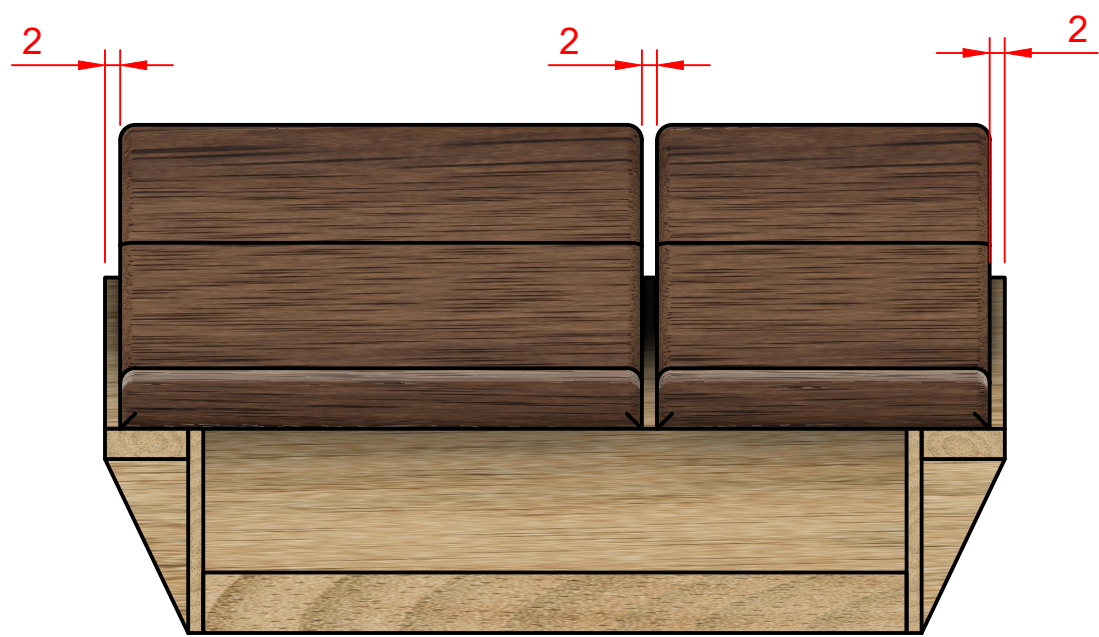

3 FRONT

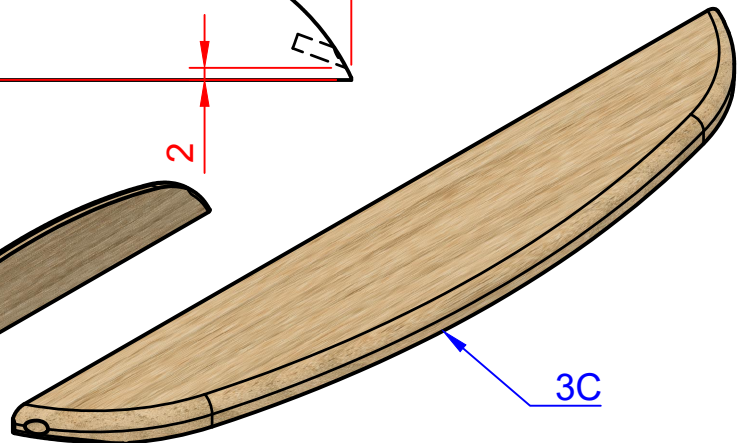
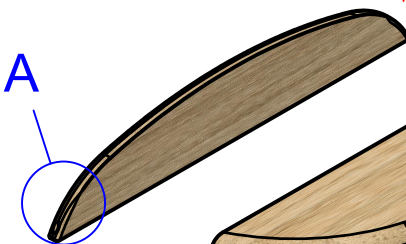
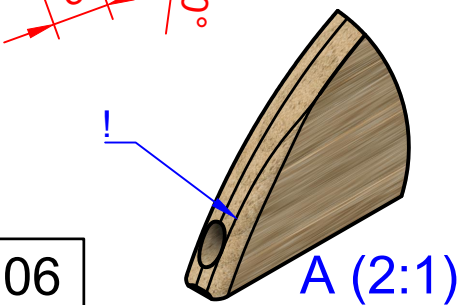
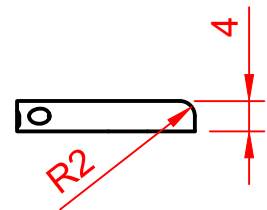
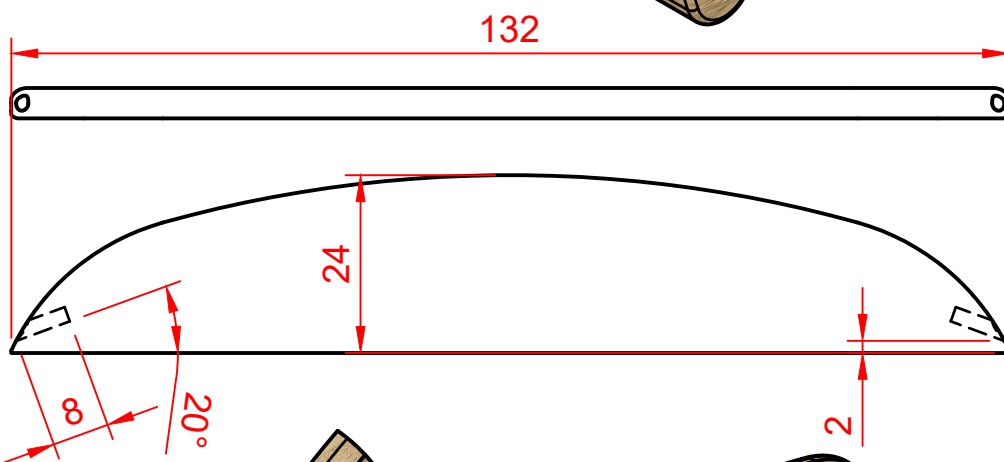
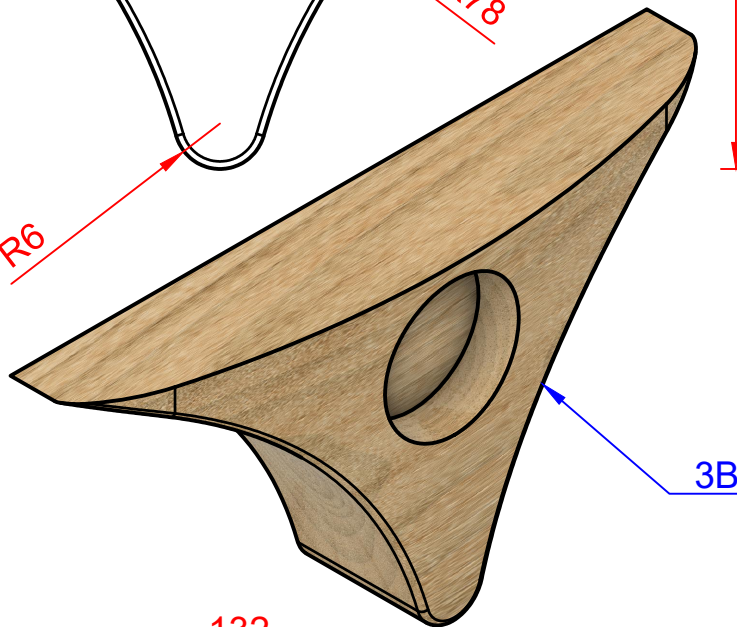
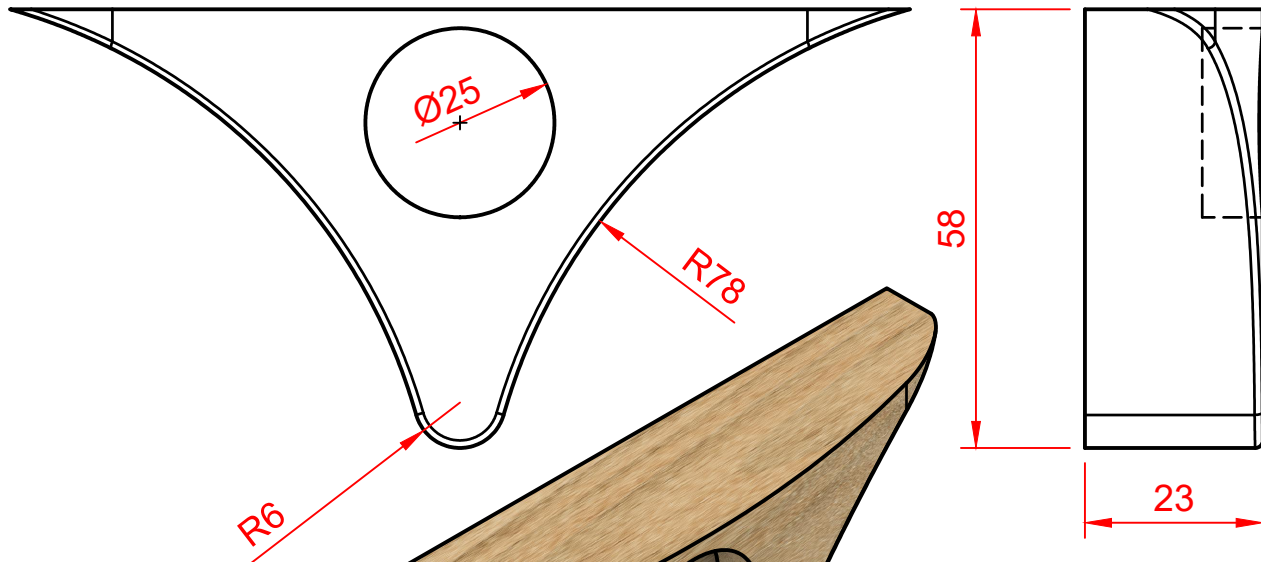
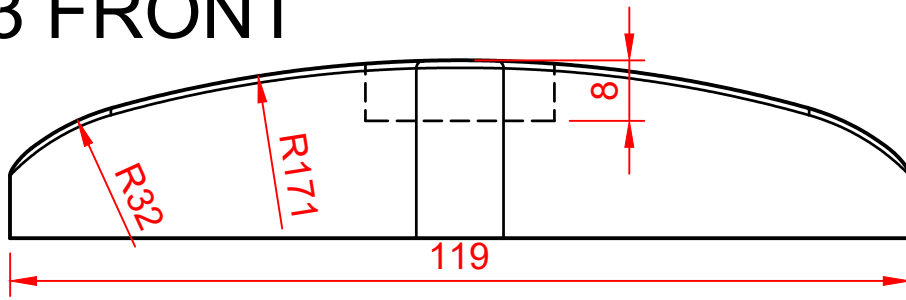

06

3 FRONT

